

Ty-Met™



Stainless steel cable ties
The ultimate solution

Thomas & Betts

Features & Benefits

Stainless steel cable ties

The Ty-Met™ stainless steel ties are the ultimate solution to install your cables in extreme conditions and hazardous areas, indoor and outdoor, such as the petrochemical and food processing industries, power stations, mining, shipbuilding, offshore and other aggressive environments.

Ball-Lock Type

Easy application and strong self-locking mechanism (steel ball), with low insertion force

304 grade stainless steel, or corrosion resistant 316 grade stainless steel



Now available in 4 different widths (up to 16mm) to suit even the most demanding applications



Rounded edges and smooth surfaces, for fast and safe hand installation

Uncoated or fully coated with non-toxic, Halogen free Polyester

Angled / rounded tail, for safer handling and easier insertion

Ladder Type

Self-locking mechanism (pawl and ratchet)

Corrosion resistant 316 grade stainless steel, for high mechanical and chemical durability

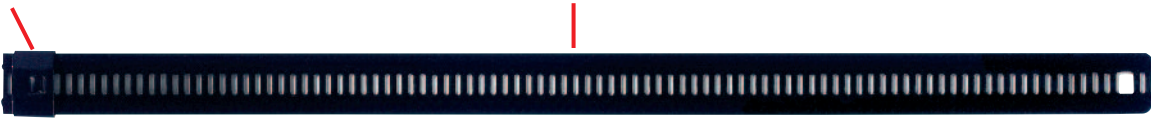

Low profile, flat head (no sharp edges), for easy and safe installation

Uncoated or fully coated with non-toxic, Halogen free Polyester

Larger slot at the end, allows the use of a hook-type tool

Releasable Type

The unique buckle design allows the tie to be unfastened for re-use

Corrosion resistant 316 grade stainless steel, for high mechanical and chemical durability

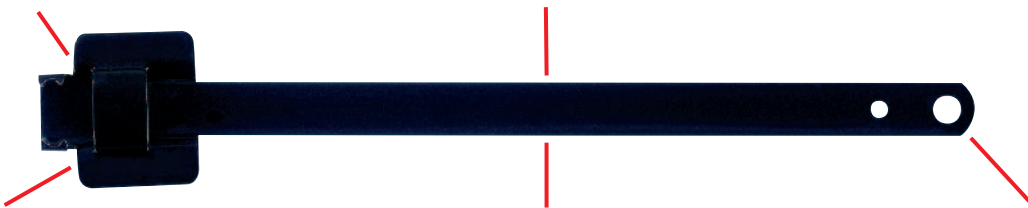

Additional ears can be bent back over the fastened tie to increase the tensile strength

Fully coated with non-toxic, Halogen free Polyester

Can be installed by hand, and if necessary, the slots at the end allow the use of a hook-type tool



UV-resistant



Fire-proof

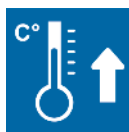

Heat resistant

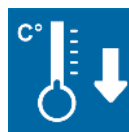

Low temperature flexibility



Weatherproof



Radiation resistant



Chemically resistant

Features & Benefits

Stainless steel cable ties

ID System



Durable identification system for tough environments and extreme conditions, indoor and outdoor

Characters and carrier strips are made of corrosion resistant 316 grade stainless steel, for high mechanical and chemical durability

Dedicated carrier strips for 6, 10 or 16 characters

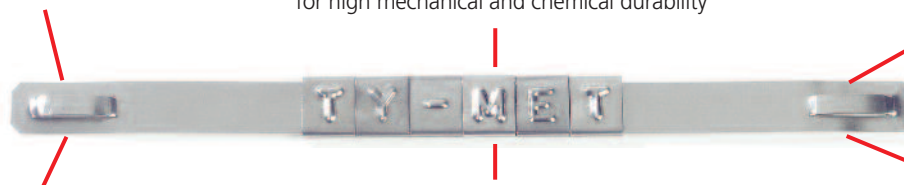

Characters can be mounted on carrier strips or directly onto Ty-Met™ stainless steel ties

Pre-embossed characters are easy to read even when covered with dust, paint or dirt

Carrier strips can be secured with Ty-Met™ stainless steel ties

Bands on Reel with Separate Heads



Bands and separate heads are made of corrosion resistant 316 grade stainless steel, for high mechanical and chemical durability

Available in 5 widths up to 19.1 mm, to suit a wide range of applications



Dedicated heads are easy to install

Bands are fully covered with non-toxic, halogen free Polypropylene

25-metre reels for a cost saving and customised installation, around all sizes and shapes of objects

All-Round Bands



Multi-purpose perforated bands, for all kinds of applications

Uncoated version available in 3 different materials: galvanised steel, stainless steel or aluminium

Can be secured with screws, nuts or bolts



Also available with straight edges (in uncoated galvanised steel)

Fully coated version (in galvanised steel)

Up to 3 different widths

Ball-Lock Type - Standard widths, uncoated

Stainless steel cable ties



* Some approvals may not be applicable to all the Product References. Contact your Sales Office for approvals limitations

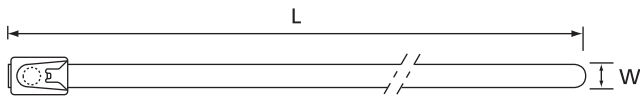

The Ball-Lock Type stainless steel ties from Thomas & Betts are self-locking, requiring no time consuming crimping or folding operations.

- Strong self-locking mechanism (stainless steel ball), with low insertion force
- Fast, easy and reliable installation
- Standard widths (4.6 mm & 7.9 mm), suitable for most applications, indoor and outdoor
- Uncoated version, suitable for high temperature environments
- 2 grades of non-magnetic stainless steel: 304 grade for standard applications and 316 grade (marine grade) for extra corrosion resistance
- Applications: installation of cables and pipes in extreme conditions and hazardous areas, such as: petrochemical and food processing industries, power stations, mining, shipbuilding, offshore and other aggressive environments

Technical Information

Material	A. 304 grade non-magnetic stainless steel B. 316 grade non-magnetic stainless steel
Temperature range	-80°C to +538°C
Colour	Metallic
Flammability rating	Absolutely fireproof
Other properties	UV-resistant

Product Ref. Stainless steel 304	Product Ref. Stainless steel 316	Length L [mm]	Width W [mm]	Material thickness [mm]	Maximum bundle diameter [mm]	Minimum tensile strength [N]	Quantity [pieces]	Tooling
YLS-4.6-100A	YLS-4.6-100B	100	4.6	0.26	20	440	100	
YLS-4.6-125A	YLS-4.6-125B	125	4.6	0.26	22	440	100	
YLS-4.6-150A	YLS-4.6-150B	150	4.6	0.26	24	440	100	
YLS-4.6-200A	YLS-4.6-200B	200	4.6	0.26	50	440	100	
YLS-4.6-300A	YLS-4.6-300B	300	4.6	0.26	80	440	100	
YLS-4.6-360A	YLS-4.6-360B	360	4.6	0.26	100	440	100	
YLS-4.6-520A	YLS-4.6-520B	520	4.6	0.26	150	440	100	
YLS-4.6-680A	YLS-4.6-680B	680	4.6	0.26	200	440	100	
YLS-4.6-840A	YLS-4.6-840B	840	4.6	0.26	250	440	100	
YLS-4.6-1000A	YLS-4.6-1000B	1000	4.6	0.26	300	440	100	
YLS-4.6-1200A	YLS-4.6-1200B	1200	4.6	0.26	365	440	100	
YLS-4.6-1400A	YLS-4.6-1400B	1400	4.6	0.26	425	440	100	CT3
YLS-7.9-100A	YLS-7.9-100B	100	7.9	0.26	20	1110	100	CT6
YLS-7.9-125A	YLS-7.9-125B	125	7.9	0.26	22	1110	100	
YLS-7.9-150A	YLS-7.9-150B	150	7.9	0.26	24	1110	100	
YLS-7.9-200A	YLS-7.9-200B	200	7.9	0.26	50	1110	100	
YLS-7.9-300A	YLS-7.9-300B	300	7.9	0.26	80	1110	100	
YLS-7.9-360A	YLS-7.9-360B	360	7.9	0.26	100	1110	100	
YLS-7.9-520A	YLS-7.9-520B	520	7.9	0.26	150	1110	100	
YLS-7.9-680A	YLS-7.9-680B	680	7.9	0.26	200	1110	100	
YLS-7.9-840A	YLS-7.9-840B	840	7.9	0.26	250	1110	100	
YLS-7.9-1000A	YLS-7.9-1000B	1000	7.9	0.26	300	1110	100	
YLS-7.9-1200A	YLS-7.9-1200B	1200	7.9	0.26	365	1110	100	
YLS-7.9-1400A	YLS-7.9-1400B	1400	7.9	0.26	425	1110	100	

Ball-Lock Type - Standard widths, fully coated Stainless steel cable ties

The Ball-Lock Type stainless steel ties from Thomas & Betts are self-locking, requiring no time consuming crimping or folding operations.

- Strong self-locking mechanism (stainless steel ball), with low insertion force
- Fast, easy and reliable installation
- Standard widths (4.6 mm & 7.9 mm), suitable for most applications, indoor and outdoor
- Corrosion resistant 316 grade stainless steel (marine grade) for high mechanical and chemical durability
- Fully coated version with non-toxic, halogen free Polyester coating, for a superior protection of cables and installer's hands and for an improved insulation between dissimilar materials.
- Applications: installation of cables and pipes in extreme conditions and hazardous areas, such as: petrochemical and food processing industries, power stations, mining, shipbuilding, offshore and other aggressive environments



Technical Information

Material	316 grade non-magnetic stainless steel
Coating	Polyester
Temperature range	-80°C to +150°C
Colour	Black
Flammability rating	Absolutely fireproof
Other properties	UV-resistant, Halogen free, non toxic

* Some approvals may not be applicable to all the Product References. Contact your Sales Office for approvals limitations

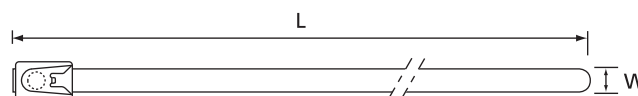

Product Ref.	Length L [mm]	Width W [mm]	Material thickness [mm]	Maximum bundle diameter [mm]	Minimum tensile strength [N]	Quantity [pieces]	Tooling
YLS-4.6-100BC	100	4.6	0.36	20	440	100	
YLS-4.6-125BC	125	4.6	0.36	22	440	100	
YLS-4.6-150BC	150	4.6	0.36	24	440	100	
YLS-4.6-200BC	200	4.6	0.36	50	440	100	
YLS-4.6-300BC	300	4.6	0.36	80	440	100	
YLS-4.6-360BC	360	4.6	0.36	100	440	100	
YLS-4.6-520BC	520	4.6	0.36	150	440	100	
YLS-4.6-680BC	680	4.6	0.36	200	440	100	
YLS-4.6-840BC	840	4.6	0.36	250	440	100	
YLS-4.6-1000BC	1000	4.6	0.36	300	440	100	
YLS-4.6-1200BC	1200	4.6	0.36	365	440	100	
YLS-4.6-1400BC	1400	4.6	0.36	425	440	100	
YLS-7.9-100BC	100	7.9	0.36	20	530	100	CT3
YLS-7.9-125BC	125	7.9	0.36	22	530	100	CT6
YLS-7.9-150BC	150	7.9	0.36	24	530	100	
YLS-7.9-200BC	200	7.9	0.36	50	530	100	
YLS-7.9-300BC	300	7.9	0.36	80	530	100	
YLS-7.9-360BC	360	7.9	0.36	100	530	100	
YLS-7.9-520BC	520	7.9	0.36	150	530	100	
YLS-7.9-680BC	680	7.9	0.36	200	530	100	
YLS-7.9-840BC	840	7.9	0.36	250	530	100	
YLS-7.9-1000BC	1000	7.9	0.36	300	530	100	
YLS-7.9-1200BC	1200	7.9	0.36	365	530	100	
YLS-7.9-1400BC	1400	7.9	0.36	425	530	100	

Ball-Lock Type - Heavy-duty ties, uncoated

Stainless steel cable ties

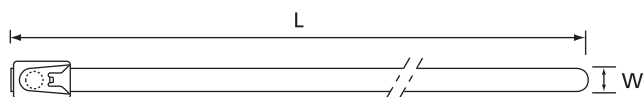

The Ball-Lock Type stainless steel ties from Thomas & Betts are self-locking, requiring no time consuming crimping or folding operations.

- Strong self-locking mechanism (stainless steel ball), with low insertion force
- Fast, easy and reliable installation
- **Heavy-duty version (12 mm & 16 mm of width), for extreme applications, indoor and outdoor**
- Uncoated version, suitable for high temperature environments
- Corrosion resistant 316 grade stainless steel (marine grade) for high mechanical and chemical durability
- Applications: installation of cables and pipes in extreme conditions and hazardous areas, such as: petrochemical and food processing industries, power stations, mining, shipbuilding, offshore and other aggressive environments

Technical Information

Material	316 grade non-magnetic stainless steel
Temperature range	-80°C to +538°C
Colour	Metallic
Flammability rating	Absolutely fireproof
Other properties	UV-resistant

Product Ref.	Length L [mm]	Width W [mm]	Material thickness [mm]	Maximum bundle diameter [mm]	Minimum tensile strength [N]	Quantity [pieces]	Tooling
YLS-12-200B	200	12.0	0.32	25	2670	50	
YLS-12-300B	300	12.0	0.32	55	2670	50	
YLS-12-360B	360	12.0	0.32	75	2670	50	
YLS-12-440B	440	12.0	0.32	102	2670	50	
YLS-12-520B	520	12.0	0.32	130	2670	50	
YLS-12-600B	600	12.0	0.32	155	2670	50	CT3
YLS-12-680B	680	12.0	0.32	180	2670	50	CT7
YLS-12-760B	760	12.0	0.32	205	2670	50	
YLS-12-840B	840	12.0	0.32	230	2670	50	
YLS-12-920B	920	12.0	0.32	255	2670	50	
YLS-12-1000B	1000	12.0	0.32	280	2670	25	
YLS-12-1200B	1200	12.0	0.32	345	2670	25	
YLS-12-1400B	1400	12.0	0.32	405	2670	25	
YLS-16-200B	200	16.0	0.32	25	3110	50	
YLS-16-300B	300	16.0	0.32	55	3110	50	
YLS-16-360B	360	16.0	0.32	75	3110	50	
YLS-16-440B	440	16.0	0.32	102	3110	50	
YLS-16-520B	520	16.0	0.32	130	3110	50	
YLS-16-600B	600	16.0	0.32	155	3110	50	
YLS-16-680B	680	16.0	0.32	180	3110	50	CT7
YLS-16-760B	760	16.0	0.32	205	3110	50	
YLS-16-840B	840	16.0	0.32	230	3110	50	
YLS-16-920B	920	16.0	0.32	255	3110	50	
YLS-16-1000B	1000	16.0	0.32	280	3110	25	
YLS-16-1200B	1200	16.0	0.32	345	3110	25	
YLS-16-1400B	1400	16.0	0.32	405	3110	25	

Ball-Lock Type - Heavy-duty ties, fully coated

Stainless steel cable ties

The Ball-Lock Type stainless steel ties from Thomas & Betts are self-locking, requiring no time consuming crimping or folding operations.

- Strong self-locking mechanism (stainless steel ball), with low insertion force
- Fast, easy and reliable installation
- **Heavy-duty version (12 mm & 16 mm of width), for extreme applications, indoor and outdoor**
- Corrosion resistant 316 grade stainless steel (marine grade) for high mechanical and chemical durability
- Fully coated version with non-toxic, halogen free Polyester coating, for a superior protection of cables and installer's hands and for an improved insulation between dissimilar materials.
- Applications: installation of cables and pipes in extreme conditions and hazardous areas, such as: petrochemical and food processing industries, power stations, mining, shipbuilding, offshore and other aggressive environments

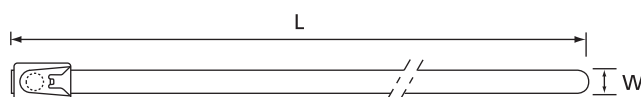

Technical Information

Material	316 grade non-magnetic stainless steel
Coating	Black Polyester
Temperature range	-80°C to +150°C
Flammability rating	Absolutely fireproof
Other properties	UV-resistant, Halogen free, non toxic

Product Ref.	Length L [mm]	Width W [mm]	Material thickness [mm]	Maximum bundle diameter [mm]	Minimum tensile strength [N]	Quantity [pieces]	Tooling
YLS-12-200BC	200	12.0	0.42	25	2000	50	
YLS-12-300BC	300	12.0	0.42	55	2000	50	
YLS-12-360BC	360	12.0	0.42	75	2000	50	
YLS-12-440BC	440	12.0	0.42	102	2000	50	
YLS-12-520BC	520	12.0	0.42	130	2000	50	
YLS-12-600BC	600	12.0	0.42	155	2000	50	
YLS-12-680BC	680	12.0	0.42	180	2000	50	CT3
YLS-12-760BC	760	12.0	0.42	205	2000	50	CT7
YLS-12-840BC	840	12.0	0.42	230	2000	50	
YLS-12-920BC	920	12.0	0.42	255	2000	50	
YLS-12-1000BC	1000	12.0	0.42	280	2000	25	
YLS-12-1200BC	1200	12.0	0.42	345	2000	25	
YLS-12-1400BC	1400	12.0	0.42	405	2000	25	
YLS-16-200BC	200	16.0	0.42	25	2000	50	
YLS-16-300BC	300	16.0	0.42	55	2000	50	
YLS-16-360BC	360	16.0	0.42	75	2000	50	
YLS-16-440BC	440	16.0	0.42	102	2000	50	
YLS-16-520BC	520	16.0	0.42	130	2000	50	
YLS-16-600BC	600	16.0	0.42	155	2000	50	
YLS-16-680BC	680	16.0	0.42	180	2000	50	CT7
YLS-16-760BC	760	16.0	0.42	205	2000	50	
YLS-16-840BC	840	16.0	0.42	230	2000	50	
YLS-16-920BC	920	16.0	0.42	255	2000	50	
YLS-16-1000BC	1000	16.0	0.42	280	2000	25	
YLS-16-1200BC	1200	16.0	0.42	345	2000	25	
YLS-16-1400BC	1400	16.0	0.42	405	2000	25	

Ladder Type - Uncoated

Stainless steel cable ties



The Ladder Type stainless steel ties from Thomas & Betts have a flat, low profile head for easy application.

- Strong self-locking mechanism (pawl and ratchet), requires no time consuming crimping or folding operations
- Flat and low profile head (no sharp edge), for easy installation
- Corrosion resistant 316 grade stainless steel (marine grade) for high mechanical and chemical durability
- Uncoated version for high temperature applications
- Increased usable length (slots up to the end of the tail), allows larger bundle diameters with the same tie length
- Larger slot at the end, allows the use of a hook-type tool
- Applications: installation of cables and pipes in extreme conditions and hazardous areas, indoor and outdoor, such as: petrochemical and food processing industries, power stations, mining, shipbuilding, offshore and other aggressive environments



* Some approvals may not be applicable to all the Product References. Contact your Sales Office for approvals limitations

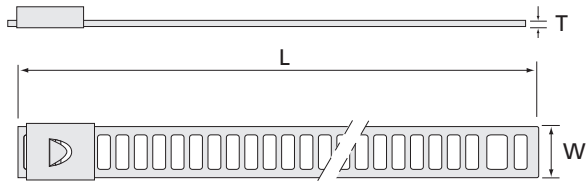

Technical Information

Material	316 grade stainless steel
Coating	Uncoated
Temperature range	-80°C to +538°C
Colour	Metallic
Flammability rating	Absolutely fireproof
Other properties	UV-resistant

Product Ref.	Length L [mm]	Width W [mm]	Thickness T [mm]	Maximum bundle diameter [mm]	Minimum tensile strength [N]	Quantity [pieces]	Tooling
YLD-7-150-B	150	7.0	0.30	43	445	100	
YLD-7-225-B	225	7.0	0.30	67	445	100	
YLD-7-300-B	300	7.0	0.30	91	445	100	CT1-TB
YLD-7-450-B	450	7.0	0.30	139	445	100	CT2-TB
YLD-7-610-B	610	7.0	0.30	190	445	100	CT3
YLD-12-150-B	150	12.0	0.35	43	890	100	CT4-TB
YLD-12-225-B	225	12.0	0.35	67	890	100	CT5
YLD-12-300-B	300	12.0	0.35	91	890	100	WT3S
YLD-12-450-B	450	12.0	0.35	139	890	100	
YLD-12-610-B	610	12.0	0.35	190	890	100	

Ladder Type - Fully coated Stainless steel cable ties

The Ladder Type stainless steel ties from Thomas & Betts have a flat, low profile head for easy application.

- Strong self-locking mechanism (pawl and ratchet), requires no time consuming crimping or folding operations
- Flat and low profile head (no sharp edge), for easy installation
- Corrosion resistant 316 grade stainless steel for high mechanical and chemical durability
- Fully coated version with non-toxic, Halogen free Polyester coating, for a superior protection of cables and installer's hands and for an improved insulation between dissimilar materials
- Increased usable length (slots up to the end of the tail), allows larger bundle diameters with the same tie length
- Larger slot at the end, allows the use of a hook-type tool
- Applications: installation of cables and pipes in extreme conditions and hazardous areas, indoor and outdoor, such as: petro-chemical and food processing industries, power stations, mining, shipbuilding, offshore and other aggressive environments



TYPE APPROVED PRODUCTS

Technical Information

Material	316 grade stainless steel
Coating	Polyester
Temperature range	-80°C to +150°C
Colour	Black
Flammability rating	Absolutely fireproof
Other properties	UV-resistant, Halogen free, non-toxic

* Some approvals may not be applicable to all the Product References. Contact your Sales Office for approvals limitations

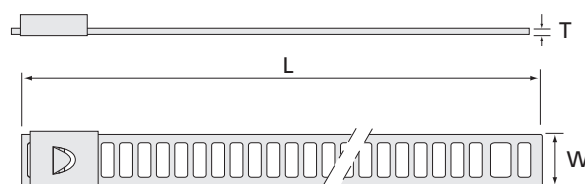

Product Ref.	Length L [mm]	Width W [mm]	Thickness T [mm]	Maximum bundle diameter [mm]	Minimum tensile strength [N]	Quantity [pieces]	Tooling
YLD-7-150-BC	150	7.0	0.30	43	445	100	
YLD-7-225-BC	225	7.0	0.30	67	445	100	
YLD-7-300-BC	300	7.0	0.30	91	445	100	CT1-TB
YLD-7-450-BC	450	7.0	0.30	139	445	100	CT2-TB
YLD-7-610-BC	610	7.0	0.30	190	445	100	CT3
YLD-12-150-BC	150	12.0	0.35	43	890	100	CT4-TB
YLD-12-225-BC	225	12.0	0.35	67	890	100	CT5
YLD-12-300-BC	300	12.0	0.35	91	890	100	WT3S
YLD-12-450-BC	450	12.0	0.35	139	890	100	
YLD-12-610-BC	610	12.0	0.35	190	890	100	

Releasable Type - Fully coated Stainless steel cable ties



* Some approvals may not be applicable to all the Product References. Contact your Sales Office for approvals limitations

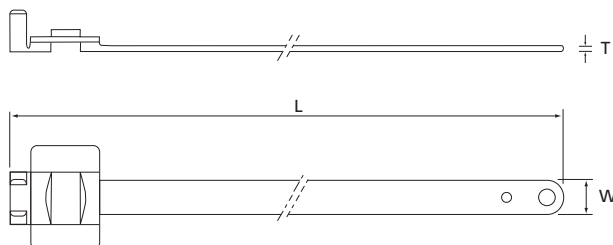

The Releasable Type stainless steel ties from Thomas & Betts have a unique buckle design that allows the ties to be unfastened for re-use.

- Releasable and re-usable
- Corrosion resistant 316 grade stainless steel for high mechanical and chemical durability
- Fully coated version with non-toxic, Halogen free Polyester coating, for a superior protection of cables and installer's hands and for an improved insulation between dissimilar materials
- Fast, easy and reliable installation - can be installed by hand and if necessary, the slots at the end of the tie allow the use of a hook type tool
- The additional ears can be bent back over the fastened tie to increase the tensile strength
- Applications: installation of cables and pipes in extreme conditions and hazardous areas, indoor and outdoor, such as: petrochemical and food processing industries, power stations, mining, shipbuilding, offshore and other aggressive environments

Technical Information

Material	316 grade stainless steel
Coating	Polyester
Temperature range	-80°C to +150°C
Colour	Black
Flammability rating	Absolutely fireproof
Other properties	UV-resistant, Halogen free, non-toxic

Product Ref.	Length L [mm]	Width W [mm]	Thickness T [mm]	Maximum bundle diameter [mm]	Minimum tensile strength [N]	Quantity [pieces]	Tooling
YRL-5-150-BC	150	5.0	0.61	35	334 (1300 for DNV)	100	
YRL-5-230-BC	230	5.0	0.61	60	334 (1300 for DNV)	100	
YRL-5-330-BC	330	5.0	0.61	95	334 (1300 for DNV)	100	
YRL-5-450-BC	450	5.0	0.61	130	334 (1300 for DNV)	100	
YRL-5-650-BC	650	5.0	0.61	195	334 (1300 for DNV)	100	CT1-TB
YRL-10-150-BC	150	10.0	0.61	35	1112 (2200 for DNV)	100	CT2-TB
YRL-10-230-BC	230	10.0	0.61	60	1112 (2200 for DNV)	100	CT4-TB
YRL-10-330-BC	330	10.0	0.61	95	1112 (2200 for DNV)	100	
YRL-10-450-BC	450	10.0	0.61	130	1112 (2200 for DNV)	100	
YRL-10-650-BC	650	10.0	0.61	195	1112 (2200 for DNV)	100	
YRL-10-750-BC	750	10.0	0.61	225	1112 (2200 for DNV)	100	
YRL-10-900-BC	900	10.0	0.61	270	1112 (2200 for DNV)	100	

Stainless steel ID system

Stainless steel cable ties

A new durable identification system, ideally suitable for tough environments and extreme conditions, indoor and outdoor.

- Sleeves with pre-embossed characters (letters, digits and symbols)
- Pre-embossed characters are raised above the surface of the sleeve, which makes them easy to read even when covered with dust, paint or dirt
- Dedicated strips can carry 6, 10 or 16 sleeves
- Sleeves and strips are made of corrosion resistant 316 grade stainless steel (marine grade), for high mechanical and chemical durability
- The sleeves can be mounted onto the carrier strips (which will be secured by Ty-Met™ stainless steel ties) or directly onto Ty-Met™ stainless steel ties having a width up to 7.9 mm

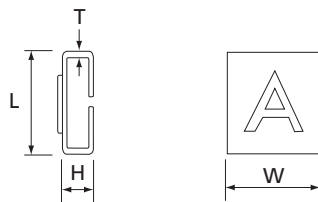

YID-CHAR-...

Sleeves with pre-embossed characters, uncoated

Product Ref.	Description	L [mm]	W [mm]	H [mm]	T [mm]	Packaging [pieces]
YID-CHAR-A	Letter "A"	9.2	8	2.5	0.25	100
YID-CHAR-B	Letter "B"	9.2	8	2.5	0.25	100
YID-CHAR-C	Letter "C"	9.2	8	2.5	0.25	100
YID-CHAR-D	Letter "D"	9.2	8	2.5	0.25	100
YID-CHAR-E	Letter "E"	9.2	8	2.5	0.25	100
YID-CHAR-F	Letter "F"	9.2	8	2.5	0.25	100
YID-CHAR-G	Letter "G"	9.2	8	2.5	0.25	100
YID-CHAR-H	Letter "H"	9.2	8	2.5	0.25	100
YID-CHAR-I	Letter "I"	9.2	8	2.5	0.25	100
YID-CHAR-J	Letter "J"	9.2	8	2.5	0.25	100
YID-CHAR-K	Letter "K"	9.2	8	2.5	0.25	100
YID-CHAR-L	Letter "L"	9.2	8	2.5	0.25	100
YID-CHAR-M	Letter "M"	9.2	8	2.5	0.25	100
YID-CHAR-N	Letter "N"	9.2	8	2.5	0.25	100
YID-CHAR-O	Letter "O"	9.2	8	2.5	0.25	100
YID-CHAR-P	Letter "P"	9.2	8	2.5	0.25	100
YID-CHAR-Q	Letter "Q"	9.2	8	2.5	0.25	100
YID-CHAR-R	Letter "R"	9.2	8	2.5	0.25	100
YID-CHAR-S	Letter "S"	9.2	8	2.5	0.25	100
YID-CHAR-T	Letter "T"	9.2	8	2.5	0.25	100

For digit 9 (nine) use digit 6 (six) upside down, for digit 0 (zero) use letter "O"

Carrier strips, uncoated

Product Ref.	Description	L [mm]	W [mm]	T [mm]	C [mm]	Packaging [pieces]
YID-STRIP-6	Carrier strip for 6 sleeves	93	7.9	0.25	75	100
YID-STRIP-10	Carrier strip for 10 sleeves	133	7.9	0.25	115	100
YID-STRIP-16	Carrier strip for 16 sleeves	188	7.9	0.25	170	100

Strips can be secured with Ty-Met™ stainless steel ties having a width up to 7.9 mm

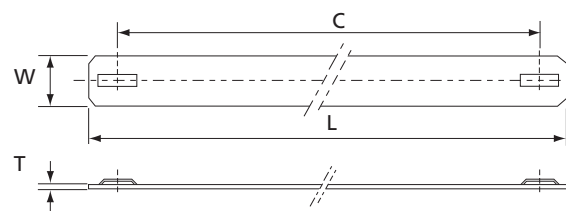

YID-STRIP-...

Product Ref.	Description	L [mm]	W [mm]	H [mm]	T [mm]	Packaging [pieces]
YID-CHAR-U	Letter "U"	9.2	8	2.5	0.25	100
YID-CHAR-V	Letter "V"	9.2	8	2.5	0.25	100
YID-CHAR-W	Letter "W"	9.2	8	2.5	0.25	100
YID-CHAR-X	Letter "X"	9.2	8	2.5	0.25	100
YID-CHAR-Y	Letter "Y"	9.2	8	2.5	0.25	100
YID-CHAR-Z	Letter "Z"	9.2	8	2.5	0.25	100
YID-CHAR-1	Digit "1"	9.2	8	2.5	0.25	100
YID-CHAR-2	Digit "2"	9.2	8	2.5	0.25	100
YID-CHAR-3	Digit "3"	9.2	8	2.5	0.25	100
YID-CHAR-4	Digit "4"	9.2	8	2.5	0.25	100
YID-CHAR-5	Digit "5"	9.2	8	2.5	0.25	100
YID-CHAR-6	Digit "6" or "9"	9.2	8	2.5	0.25	100
YID-CHAR-7	Digit "7"	9.2	8	2.5	0.25	100
YID-CHAR-8	Digit "8"	9.2	8	2.5	0.25	100
YID-CHAR-BLANK	Blank filler	9.2	8	2.5	0.25	100
YID-CHAR-PLUS	Symbol "+"	9.2	8	2.5	0.25	100
YID-CHAR-MINUS	Symbol "-"	9.2	8	2.5	0.25	100
YID-CHAR-SLASH	Symbol "/"	9.2	8	2.5	0.25	100
YID-CHAR-EARTH	Symbol "⊥"	9.2	8	2.5	0.25	100
YID-CHAR-SINE	Symbol "∞"	9.2	8	2.5	0.25	100

Bands on reel with separate heads

Stainless steel cable ties



A new range of stainless steel band on reel with separate heads, for a cost saving installation without waste

- Bands and heads are made of corrosion resistant 316 grade stainless steel, for high mechanical and chemical durability
- Bands are fully covered with a non-toxic, halogen free black Polypropylene sheath, for a superior protection of cables and installer's hands, and for an improved insulation between dissimilar materials
- Cost saving and flexible: the 25-metre reels allow a customised installation (no waste) around all sizes and shapes of objects
- Dedicated separate heads are easy to install
- Available in 5 widths up to 19.1 mm, to suit a wide range of applications

Technical Information

Material	316 grade non-magnetic stainless steel
Coating	Polypropylene
Colour	Bands & Heads: metallic Coating: black
Other properties	UV-resistant, Halogen free, non-toxic

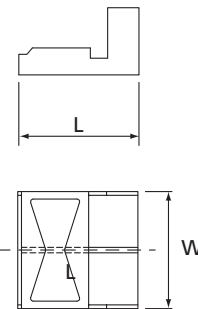
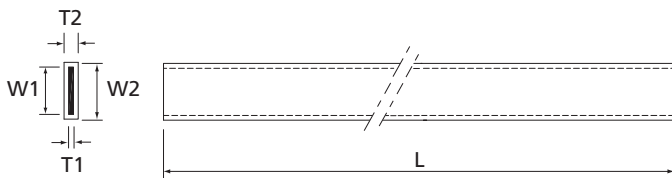

Bands on reels, fully covered with Polypropylene sheath

Product Ref.	W1 [mm]	W2 [mm]	T1 [mm]	T2 [mm]	Length [m]
YBR-6.4-25BC	6.4	7.2	0.48	1.25	25
YBR-9.5-25BC	9.5	10.3	0.48	1.25	25
YBR-12.7-25BC	12.7	13.5	0.48	1.25	25
YBR-15.9-25BC	15.9	16.7	0.48	1.25	25
YBR-19.1-25BC	19.1	18.9	0.48	1.25	25

Separate heads, uncoated

Product Ref.	W [mm]	L [mm]	Packaging [pieces]
YBRH-6.4	9.3	15.9	100
YBRH-9.5	12.0	15.9	100
YBRH-12.7	16.5	22.3	100
YBRH-15.9	19.4	22.3	100
YBRH-19.1	21.7	22.3	100

All-Round Bands

Stainless steel cable ties & Other metallic cable ties

A new range of multi-purpose perforated bands, for all kind of applications in industrial installation, maintenance, street lights, ...

- New, user-friendly plastic cassette packaging, for easier unwinding
- Easy to install around any shape of object: cable bundles, pipes, poles,...
- Can be secured with nuts, bolts, screws
- Available in different widths and materials: galvanised steel, 316 grade stainless steel or aluminium
- Galvanised steel bands are also available in coated version or with straight edges



Technical Information

Material	Galvanised steel 316 grade stainless steel Aluminium
Coating	Uncoated or coated with Polyolefin
Colour	Bands: metallic Coating: black
Other properties	UV-resistant, Halogen free, non-toxic

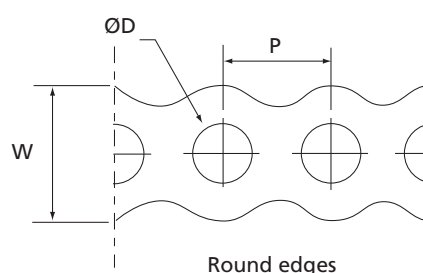
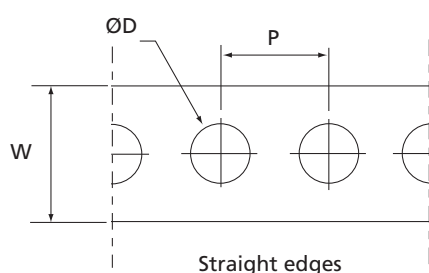

All-round bands, uncoated

Product Ref.	Shape	Material	W (width) [mm]	P [mm]	ØD [mm]	Thickness [mm]	Length [m]
ARB12-G	Round edges	Galvanised steel	12	14	5	0.8	10
ARB17-G	Round edges	Galvanised steel	17	20	7	0.8	10
ARB26-G	Round edges	Galvanised steel	26	25	8	1.0	10
ARB12-B	Round edges	316 grade stainless steel	12	14	5	0.8	10
ARB17-B	Round edges	316 grade stainless steel	17	20	7	0.8	10
ARB12-AL	Round edges	Aluminium	12	14	5	1.0	10
ARB17-AL	Round edges	Aluminium	17	20	7	1.0	10
ARB12-G-STR	Straight edges	Galvanised steel	12	8	5	0.8	10
ARB17-G-STR	Straight edges	Galvanised steel	17	12	7	0.8	10
ARB26-G-STR	Straight edges	Galvanised steel	26	14	8	1.0	10

All-round bands, fully coated

Product Ref.	Shape	Material	W (width) [mm]	P [mm]	ØD [mm]	Thickness [mm]	Length [m]
ARB12-GC	Round edges	Galvanised steel	12	14	5	0.8	10
ARB17-GC	Round edges	Galvanised steel	17	20	7	0.8	8

Tools for stainless steel ties

Fastening tools

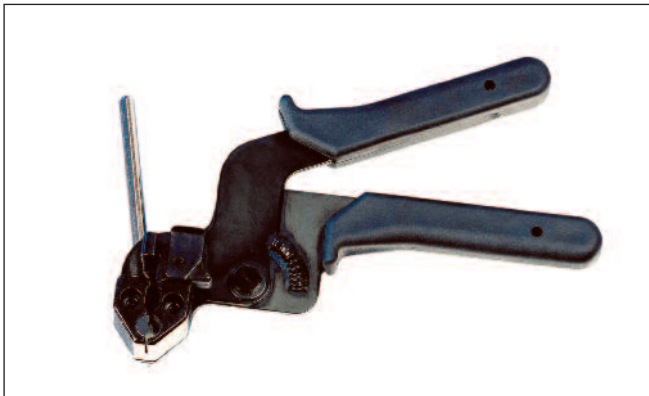

Product Ref.: CT3

- Cost-effective tensioning tool
- Cut-off by hand-activated lever

Technical Information

Tool type	Hand tool
For type of cable tie	Ladder Type & Ball-Lock Type stainless steel ties, coated and uncoated, having a width up to 12 mm
Features	Tensioning, manual cutting
Weight	550 g
Dimensions [L x W x H]	210 x 155 x 35 mm



Product Ref.: CT5 and CT6

- Adjustable tension settings
- Automatic cutting once desired tension has been reached
- CT5: for coated and uncoated Ladder Type stainless steel ties
- CT6: for coated and uncoated Ball-Lock Type stainless steel ties, having a width up to 7.9 mm

Technical Information

Tool type	Tension setting hand tool
Weight	430 g
Dimensions [L x W x H]	173 x 158 x 22 mm

NEW



Product Ref.: CT7

- Tensioning and cutting tool, ratchet type
- Suitable for coated and uncoated Ball-Lock Type stainless steel ties, having a width of 12 mm and 16 mm

Technical Information

Tool type	Hand tool, ratchet type
Weight	1300 g
Dimensions [L x W x H]	270 x 170 x 60 mm

Selection chart & Specifications

Stainless steel cable ties

Type	Material	Coating	Series	Shape	Range	Packaging	Quantity
Ball-Lock Type	304 Grade Stainless Steel	Uncoated	YLS-4.6-...A	Width: 4.6 mm	Length: 125 to 1400 mm	Bag	100 ties per bag
			YLS-7.9-...A	Width: 7.9 mm	Length: 125 to 1400 mm	Bag	100 ties per bag
	316 Grade Stainless Steel	Uncoated	YLS-4.6-...B	Width: 4.6 mm	Length: 125 to 1400 mm	Bag	100 ties per bag
			YLS-7.9-...B	Width: 7.9 mm	Length: 125 to 1400 mm	Bag	100 ties per bag
		Polyester	YLS-4.6-...BC	Width: 4.6 mm	Length: 125 to 1400 mm	Bag	100 ties per bag
			YLS-7.9-...BC	Width: 7.9 mm	Length: 125 to 1400 mm	Bag	100 ties per bag
Ball-Lock Type, Heavy-Duty	316 Grade Stainless Steel	Uncoated	YLS-12-...B	Width: 12.0 mm	Length: 200 to 1400 mm	Bag	50 / 25 ties per bag
			YLS-16-...B	Width: 16.0 mm	Length: 200 to 1400 mm	Bag	50 / 25 ties per bag
		Polyester	YLS-12-...BC	Width: 12.0 mm	Length: 200 to 1400 mm	Bag	50 / 25 ties per bag
			YLS-16-...BC	Width: 16.0 mm	Length: 200 to 1400 mm	Bag	50 / 25 ties per bag
Ladder Type	316 Grade Stainless Steel	Uncoated	YLD-7-...-B	Width: 7.0 mm	Length: 150 to 610 mm	Bag	100 ties per bag
			YLD-12-...-B	Width: 12.0 mm	Length: 150 to 610 mm	Bag	100 ties per bag
		Polyester	YLD-7-...-BC	Width: 7.0 mm	Length: 150 to 610 mm	Bag	100 ties per bag
			YLD-12-...-BC	Width: 12.0 mm	Length: 150 to 610 mm	Bag	100 ties per bag
Releasable Type	316 Grade Stainless Steel	Polyester	YRL-5-...-BC	Width: 5.0 mm	Length: 150 to 650 mm	Bag	100 ties per bag
			YRL-10-...-BC	Width: 10.0 mm	Length: 150 to 900 mm	Bag	100 ties per bag
Identification System	316 Grade Stainless Steel	Uncoated	YID-CHAR-...	Characters	All letters & digits + 6 symbols	Bag	100 pieces per bag
			YID-STRIP-...	Strips	Length: 93 to 188 mm	Bag	100 pieces per bag
Bands on Reel & Separate Heads	316 Grade Stainless Steel	Polypropylene	YBR-...-BC	Bands	Width: 6.4 - 9.5 - 12.7 - 15.9 - 19.1 mm	Reel (1)	25 metres per reel
		Uncoated	YBRH-...	Heads	Width: 6.4 - 9.5 - 12.7 - 15.9 - 19.1 mm	Bag	100 pieces per bag
All-Round Bands	Galvanised Steel	Uncoated	ARB-...-G	Round edges	Width: 12 - 17 - 26 mm	Reel (2)	10 metres per reel
			ARB-...-G-STR	Straight edges	Width: 12 - 17 - 26 mm	Reel (2)	10 metres per reel
	Polyolefine	ARB-...-GC	Round edges	Width: 12 - 17 mm	Reel (2)	10 / 8 metres per reel	
	Aluminium	Uncoated	ARB-...-AL	Round edges	Width: 12 - 17 mm	Reel (2)	10 metres per reel
	316 Grade Stainless Steel	Uncoated	ARB-...-B	Round edges	Width: 12 - 17 mm	Reel (2)	10 metres per reel

Reel (1): Reel in cardboard box
 Reel (2): Reel in plastic cassette

304 Stainless Steel

316 Stainless Steel

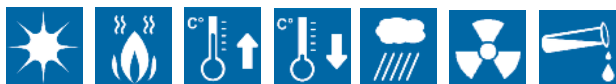

- Superior corrosion resistance
- Excellent tensile strengths at extreme temperatures
- High resistance to chemicals, acids and radiation
- 316 grade has a better resistance to saltwater corrosion and can be supplied with a coating
- Extensively used in offshore, shipbuilding, food and petrochemical industries