

Rod length	Rod diameter	Thread diameter	Material	Weight per rod	Part no.
500mm	10mm	10mm	Copper	0.33kg	RA400-FU
1000mm	10mm	10mm	Copper	0.65kg	RA402
500mm	10mm	10mm	Aluminium	0.11kg	RA080

Supplied with locknut.

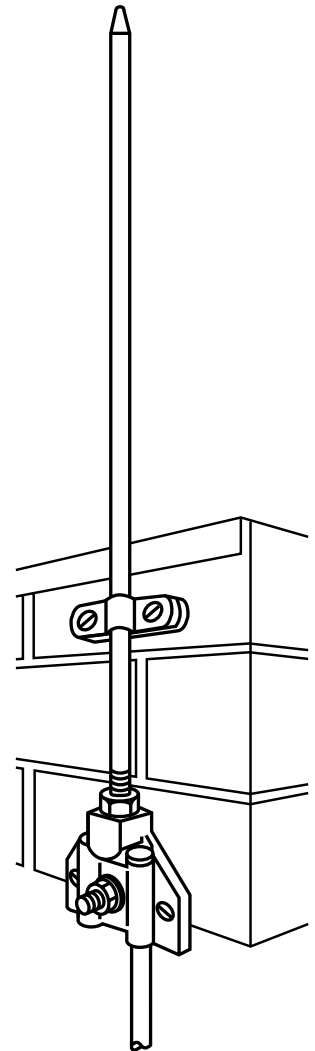

Air terminal base

Conductor diameter	Thread diameter	Conductor material	Weight each	Vertically mounted	Horizontally mounted
8	10	Copper	0.30kg	SD307	SD305
8	10	Aluminium	0.11kg	SD007	SD005

Recommended fixing - counter sunk woodscrew 1 1/2" x no.10 and wall plug.



Strike pad

Conductor material	Weight each	Part no.
Copper	0.41kg	PL010
Aluminium	0.13kg	PL005

Accessories

Description	Weight each	Part no.
Copper stem for use with PL010	0.07kg	SM010

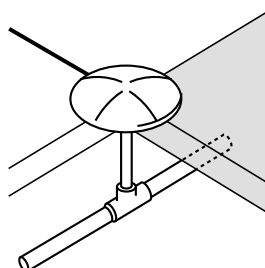

This product is supplied with a set screw to enable the lightning conductors to be attached to the strike pad. The strike pad PL010 can be used in lightning protection schemes in multi-storey car parks, using the stem SM010 connected to the re-bar cage or buried earth conductor.

## One hole cable clip

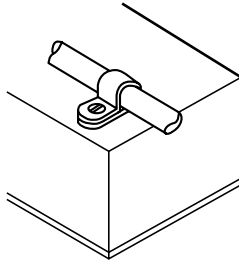

## Conductor fixings

Conductor diameter	Conductor material	Weight each	Part no.
8mm	Copper	0.01kg	<b>CP905</b>
8mm	Aluminium	0.01kg	<b>CP925</b>
10mm*	Copper	0.01kg	<b>CP915</b>
10mm*	Aluminium	0.01kg	<b>CP935</b>

Recommended fixing - round head woodscrew 1 1/2" x no.10 and wall plug.  
\* PVC covered 8mm conductor.

## Heavy duty cast cable saddle

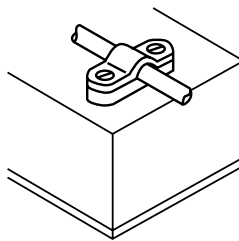

Conductor diameter	Conductor material	Weight each	Part no.
8mm	Copper	0.09kg	<b>CP805</b>
8mm	Aluminium	0.03kg	<b>CP806</b>
10mm*	Copper	0.10kg	<b>CP815</b>
10mm*	Aluminium	0.04kg	<b>CP816</b>

\* For use with pvc covered 8mm conductor or for supporting air terminals when used in conjunction with wall mounted air terminal base. Can also be used with glazing bar holdfast and back plate holdfast stem.  
Recommended fixing - counter sunk woodscrew 1 1/2" x no.10 and wall plug.

## Push-in plastic cable clip

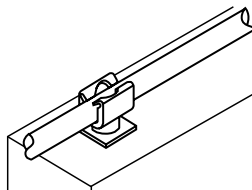

Conductor diameter	Weight each	Part no.		Colour range		
		Black	Grey	Stone	White	Brown
8mm	0.01kg	-	<b>CP872</b>	-	-	<b>CP887</b>
10mm*	0.01kg	<b>CP861</b>	<b>CP871</b>	<b>CP876</b>	<b>CP881</b>	<b>CP886</b>

Recommended fixing - counter sunk woodscrew 1 1/2" x no.10 and wall plug.  
\* PVC covered 8mm conductor.

## Conductor fixings

### Weldable push-in clip

For use with PVC roofing only

Conductor size	Colour	Weight each	Part no.
8mm	Grey	0.03kg	CW872
8mm	Brown	0.03kg	CW887
10mm*	Grey	0.03kg	CW871
10mm*	Brown	0.03kg	CW886

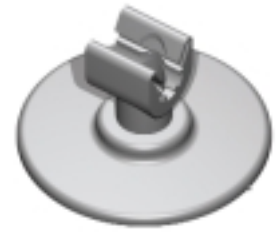
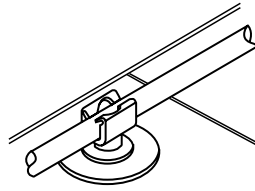

\* PVC covered 8mm conductor.

### Accessories for weldable clips

Description	Weight each	Part no.
Universal welding solvent 500ml spray applicator (sufficient for the application of approximately 200 clips) For use with Furse weldable clips only.	0.57kg	CW905

Description	Weight each	Part no.
Cleaning solution (Acetone) For cleaning lacquered SARNAFIL roofing membranes and other lacquered materials. 500ml spray applicator	0.62kg	CW999



Please note: Solvent cannot be used outside the UK. For overseas projects, please contact Furse for advice.

### Adhesive push-in clip

For use on surfaces other than PVC roofing

Conductor diameter	Weight each	Part no.		Colour range		
		Black	Grey	Stone	White	Brown
8	0.02	-	CA872	-	-	CA887
10*	0.02	CA861	CA871	CA876	CA881	CA886

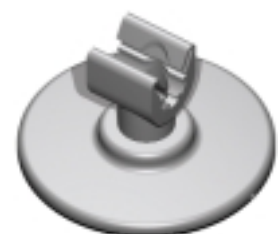
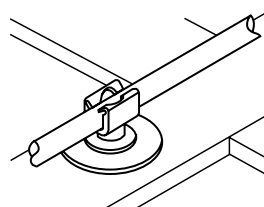

Description	Weight each	Part no.
Surface primer 250ml spray applicator (sufficient for the application of approx. 500 clips)	0.24kg	CA900

Note: Furse strongly recommend use of the primer when installing Furse adhesive clips.

\* PVC covered 8mm conductor.

## Non metallic slate holdfast

## Conductor fixings

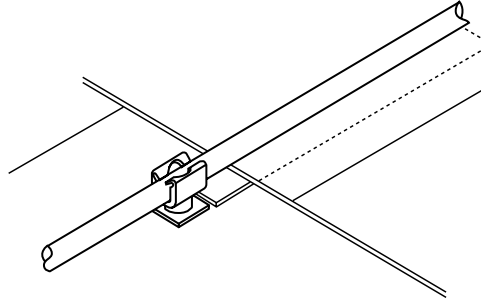

Conductor diameter	Colour	Weight each	Part no.
8mm	Brown	0.03kg	HF176
8mm	Grey	0.03kg	HF191

Variations of tail length, clip size and clip colour can be made to order as special items.

## Pyramid holdfast



Type	Weight each	Part no.
Filled	0.97kg	HF975

Supplied filled with concrete, they can be used to hold conductors on flat surfaces. The lip around the base allows them to be built into bitumen type roofs, etc. Suitable for 8mm diameter bare conductor.

## Test and junction clamps

### Square clamp

Conductor diameter	Conductor material	Weight each	Part no.
8mm	Copper	0.17kg	CS605
8mm	Aluminium	0.07kg	CS610

For forming cross or tee joints.

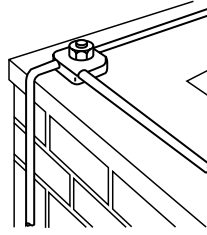

### Tee clamp

Conductor diameter	Conductor material	Weight each	Part no.
8mm	Copper	0.17kg	CS505
8mm	Aluminium	0.07kg	CS510

For forming tee joints.

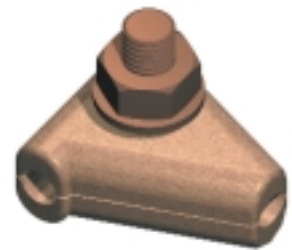
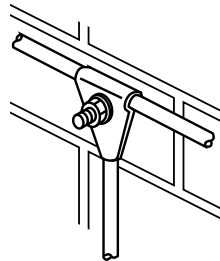

### Jointing clamp

Conductor diameter	Conductor material	Weight each	Part no.
8mm	Copper	0.17kg	CS405
8mm	Aluminium	0.08kg	CS410

For forming straight through joints.

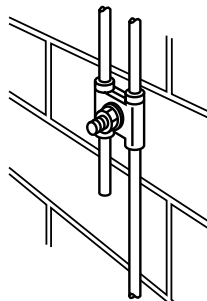

## Test clamp

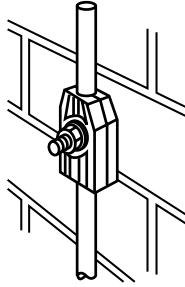

## Test and junction clamps

Conductor diameter	Conductor material	Weight each	Part no.
8mm	Copper	0.20kg	CN305
8mm	Aluminium	0.09kg	CN310

For forming straight through joints or for disconnection and test purposes.

Also available for connecting 8mm diameter conductor to 25 x 3mm conductor.

## Bimetallic connector

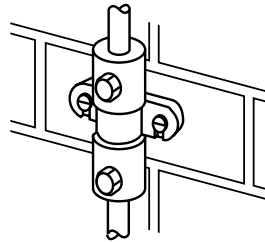

Conductor diameter	Weight each	Part no.
8mm diameter aluminium conductor to 8mm diameter copper conductor	0.25kg	CN915
8mm diameter aluminium conductor to 25mm x 3mm copper tape	0.19kg	CN920

For joining aluminium and copper circular conductors. Particularly useful where an aluminium lightning protection system needs to be earthed using copper.

## Oxide inhibiting compound



Plastic bottle each	Part no.
0.23kg (8oz)	CM005

For all the items in this range we recommend the use of oxide inhibitor when aluminium fittings are installed.

Oxide inhibitor is a non-water soluble, natural-petroleum based polymer grease that seals electrical connections from oxygen and moisture.

## Bonds and clamps

### Metalwork bond

Conductor diameter	Conductor material	Weight each	Part no.
8mm	Copper	0.37kg	<b>CS350</b>
8mm	Aluminium	0.17kg	<b>CS355</b>

For connecting to all types of metal structures up to 13mm thickness.

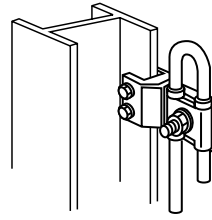

### Pipe bond

Conductor diameter	Pipe diameter	Conductor material	Weight each	Part no.
8mm	50-200mm	Copper	0.46kg	<b>BN175</b>
8mm	50-200mm	Aluminium	0.25kg	<b>BN176</b>

For bonding to ducts and large diameter pipeworks.

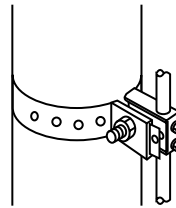

### Re-bar clamp

Conductor diameter	Pipe diameter	Conductor material	Weight each	Part no.
8mm	8-18mm	Copper	0.32kg	<b>BN150</b>
8mm	18-38mm	Copper	0.75kg	<b>BN155</b>

For bonding to re-inforcing bars, steam pipes, handrails etc.

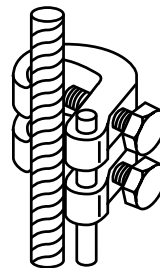

## Tower earth clamp

## Bonds and clamps

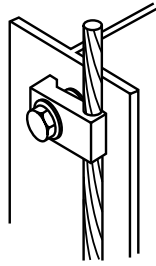

Conductor diameter	Channel thickness	Bolt size	Conductor material	Weight each	Part no.
8mm	10mm	M10	Copper	0.08kg	<b>BN300-FU</b>
8mm	10mm	M10	Aluminium	0.05kg	<b>BN305</b>

For bonding copper and aluminium conductors to steel work.

## Straight setscrew type cable socket

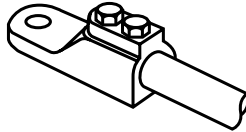

Conductor diameter	Palm hole diameter	Conductor material	Weight each	Part no.
8mm	12mm	Copper	0.11kg	<b>SX450</b>
8mm	12mm	Aluminium	0.05kg	<b>SX455</b>